THE GIANT-VAC GREENS MOWER CADDY

MODEL 1030

OPERATOR'S MANUAL

Congratulations!

You have just purchased one of the finest outdoor power equipment accessories on the market today. If properly cared for, your Giant-Vac Greens Mower Caddy will provide years of dependable service. Please read and follow this instruction manual carefully in order to get the most out of your new equipment.

Each Giant-Vac product leaves our factory in excellent condition; occasionally, however, some damage may occur during shipment. If any such damage is found upon initial inspection, *immediately* notify the transport carrier who delivered your machine, as they are solely responsible for such damage, as well as any subsequent adjustments necessary.

Your Giant-Vac Greens Mower Caddy comes completely assembled. Simply follow the instructions contained within this manual to begin enjoying the benefits of your new unit.

1. CONNECT UNIT TO TOWING VEHICLE

- Hook draw bar of unit to hitch of towing vehicle and secure with hitch pin (not supplied). **Note: Be keenly aware of the unit's presence on the rear of the towing vehicle, especially when backing up or negotiating tight turns.**

2. MOUNT MOWER ONTO CADDY

- Remove transport wheels on mower.
- Roll mower onto caddy, adjusting front brackets and rear brackets so that when front roller of mower butts against rear of front brackets, rear axle of mower sets into v-shaped catch of rear bracket. (see picture)
- Tighten thumb screws on both front and rear brackets.



- Lay transport wheels on deck of caddy next to front brackets.

GIANT-VAC WARRANTY

GIANT-VAC, INC., here-in-after called Giant-Vac, warrants each new Giant-Vac to the original retail purchaser of the new Giant-Vac equipment to be free from manufacturing defects in normal service for a period of 1 year, unless it is used for rental purposes, which limits the warranty to 30 days. This warranty does not apply to engines, tires or other parts that are purchased and warranted by their manufacturer. Items such as bags, grass catchers, hoses and blades are not warranted, as these are considered expendable items. This warranty does not include equipment failures due to normal wear.

Any obligation under this warranty is expressly limited to the replacement or repair, at an authorized servicing Giant-Vac dealer, or at a point designated by us, of such parts as appear to us to have been defective. All defective parts have to be returned freight prepaid before credit will be issued.

We shall not be liable for transportation charges in connection with the replacement or repair of defective parts.

This warranty does not apply to a Giant-Vac upon which repairs or alterations have been made by others except with our prior written approval.

We shall not be liable for consequential damages or contingent liabilities for the fitness of any Giant-Vac for any particular purpose.

We make no other express, implied or statutory warranty, nor is anyone authorized to make any in our behalf.

**GIANT-VAC, INC.
P.O. BOX 195
SOUTH WINDHAM, CT. 06266
PHONE: 860-423-7741 • FAX: 860-423-2654**

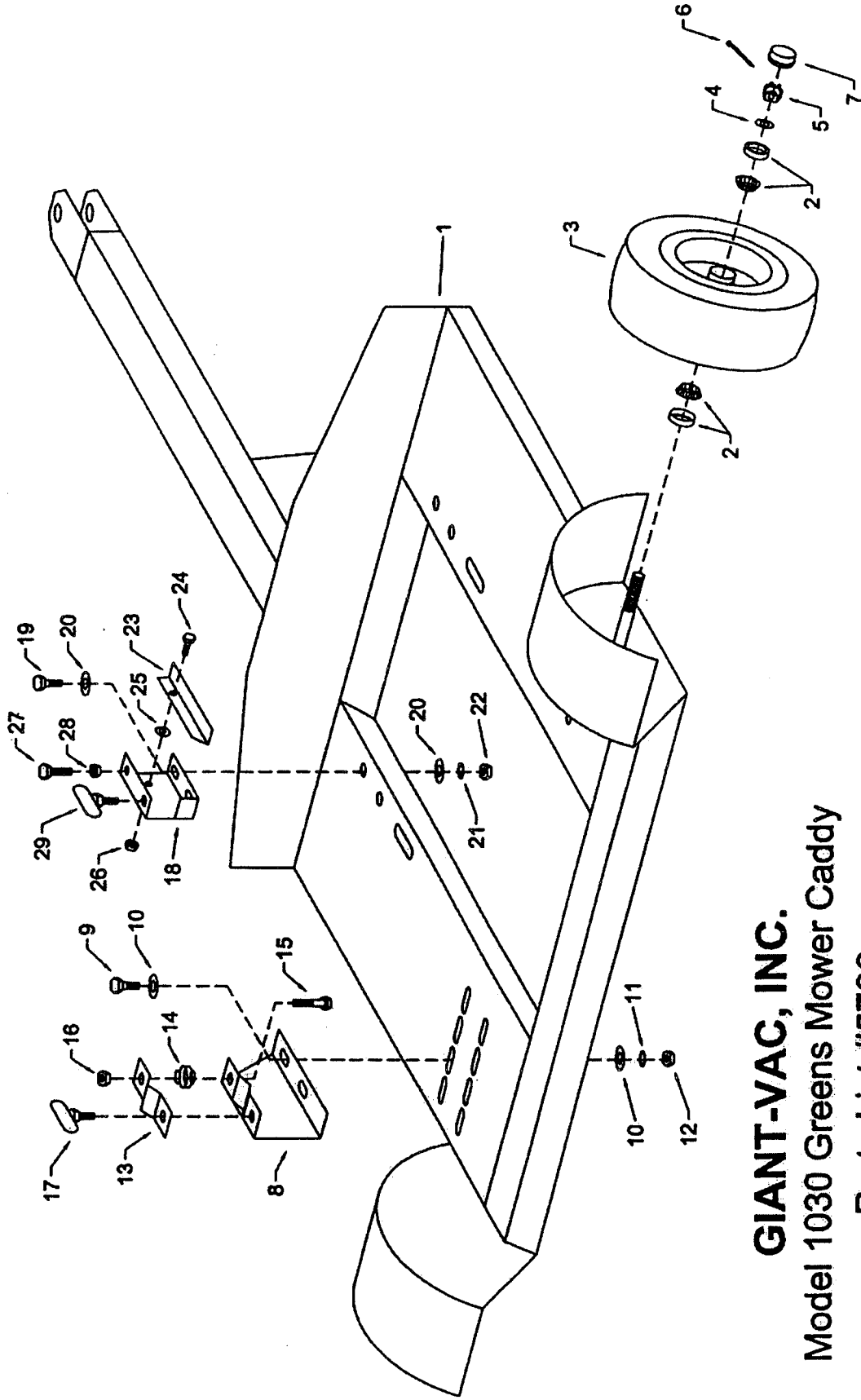

GIANT-VAC, INC.
 Model 1030 Greens Mower Caddy
 Parts List #5796

PARTS LIST NO. 5796

1030 GREENS MOWER CADDY

<u>REF.</u> <u>NO.</u>	<u>PART</u> <u>NO.</u>	<u>DESCRIPTION</u>	<u>QTY</u>
1	10225	Towing base & draw bar assy	1
2	33122	Wheel bearing & seal - 3/4"	4
3	33120	Wheel & tire assy - 410-350 x 6	2
4	31853	3/4" flatwasher	2
5	31451	3/4-25 castle nut	2
6	31783	Cotter pin - 1/8" x 1-1/2" oal	2
7	33228	Dust cap	2
8	27363	Rear mounting bracket - left	1
8a	27364	Rear mounting bracket - right	1
9	31033	3/8-16 x 1 hex bolt (bracket to towing base)	4
10	31034	3/8" flat washer	8
11	31008	3/8" lock washer	4
12	31009	3/8-16 hex nut	4
13	27365	Mounting bracket top locking plate	2
14	23179	Locking plate spring	2
15	31461	1/2-13 x 2-1/2" hex bolt (top plate to bracket)	2
16	31637	1/2-13 nylon lock nut	2
17	31855	1/2-13 x 3" thumb bolt	2
18	27366	Front mounting bracket - left	1
18a	27367	Front mounting bracket - right	1
19	31033	3/8-16 x 1 hex bolt (bracket to towing base)	4
20	31034	3/8" flat washer	8
21	31008	3/8" lock washer	4
22	31009	3/8-16 hex nut	4
23	27368	Lifter tongue - left	1
23a	27369	Lifter tongue - right	1
24	31033	3/8-16 x 1 hex bolt (tongue to bracket)	2
25	31034	3/8" flat washer	2
26	31388	3/8-16 lock nut	2
27	31816	3/8-16 x 2 full thread hex bolt (tongue angle adjust)	2
28	31009	3/8-16 hex nut	2
29	31855	1/2-13 x 3" thumb bolt	2

SPECIFICATIONS SUBJECT TO CHANGE WITHOUT NOTICE