

INSTRUCTIONS FOR INSTALLING THE MOWER CHUTE

IMPORTANT

REMOVE SPARK PLUG ON VACUUM AND
RIDING MOWER OR TRACTOR BEFORE
ATTEMPTING TO WORK ON EITHER
UNIT OR TO CLEAN EITHER UNIT.

ASSEMBLY OF MOWER CHUTE: First, remove the deflector if the mower is so equipped. Then measure the length and the height of the mower deck. Next, adjust the mower chute to be a little bit larger than the deck. Hold the chute up to the deck and check to make sure that the chute clears the cutter blades and the mower itself. PLEASE NOTE: BEFORE DRILLING ANY HOLES IN THE MOWER DECK, MAKE SURE THE CHUTE CLEARS THE CUTTER BLADES. Once clearance has been thoroughly checked, mark the mower deck with a pencil and drill two holes on the top as far apart as possible and drill one hole in the side of the cutter deck. This hole will also have to be drilled in the mower chute. Attach the mower chute to the mower deck, again checking the clearance of the cutter blades, and fasten it down with two 5/16 x 3/4" bolts, lockwashers, nuts and flat washers Ref. #56 and one 5/16 x 3/4" bolt, lockwasher and flat washer Ref. #55. Put the intake hose Ref. #33 onto the intake flange and onto the chute, using two 6" hose clamps Ref. #34 to hold it in place. Place the hose boom Ref. #15 onto the holder of the power unit. Catch one hook on the rubber hose holder Ref. # 16 in the loop on the hose boom. Loop the other end under the intake hose Ref. #33 and then catch it in the loop on the hose boom along with the other hook. Adjust position of boom as needed to keep the intake hose out of the way of the mower.

PLEASE NOTE: ALL MOWER GUARDS MUST BE RE-INSTALLED IF THE CUTTER DECK IS GOING TO BE OPERATED WITHOUT THE MOWER CHUTE.

OPTIONAL HOSE ATTACHMENT: You may install an intake hose attachment by removing the suction hose and installing a 6" x 10' intake hose with nozzle onto the intake flange - already on the power unit. This will enable you to clean around shrubs and pick up leaves that have been windrowed.

WARRANTY: Within 90 days from the purchase date, GIANT-VAC MFG. INCORPORATED will replace free of charge for the original purchaser, any part or parts returned to the factory at South Windham, Connecticut, and found by us to be defective in material and/or workmanship.

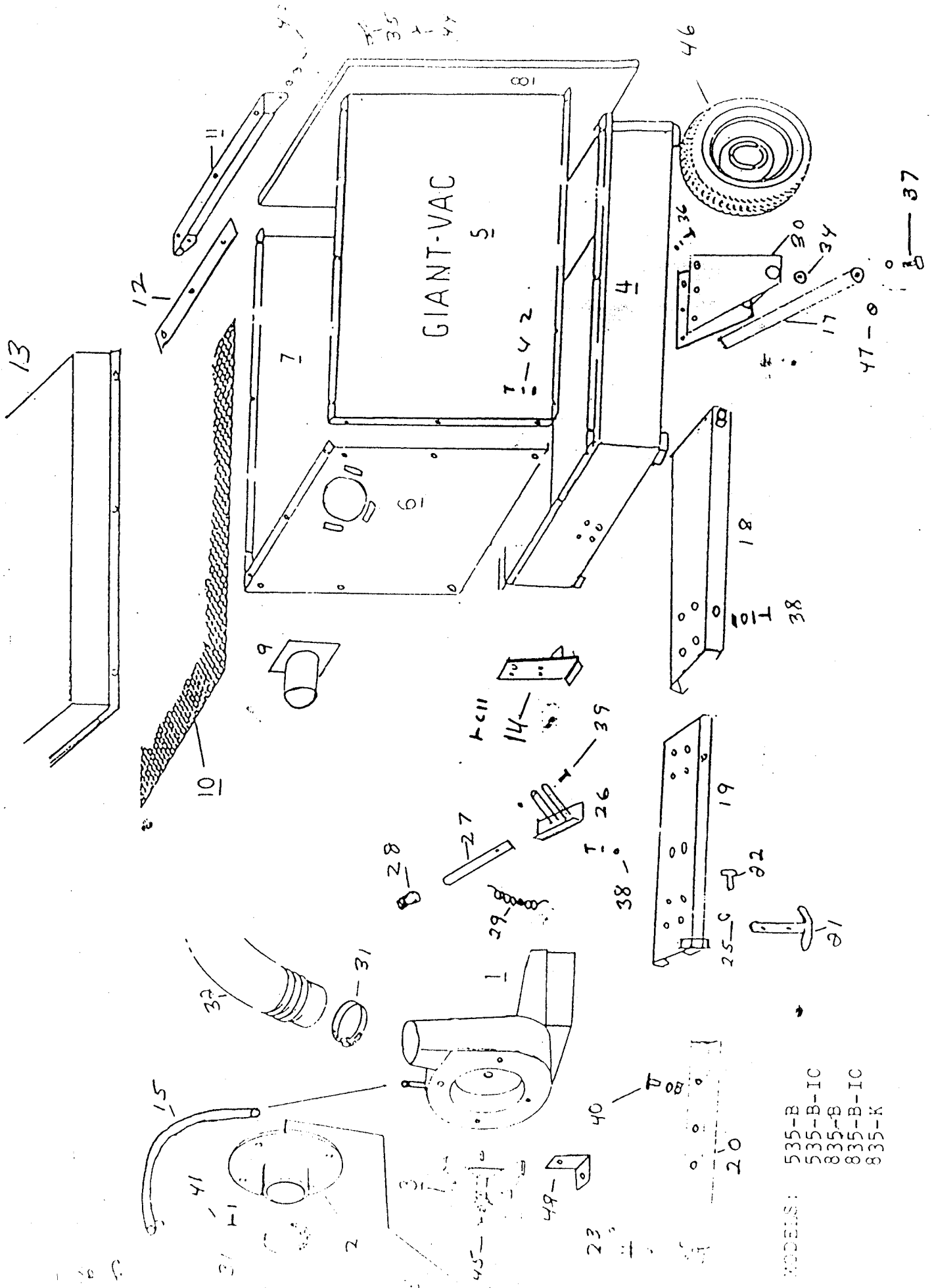

- MODELS:
- 535-B
 - 535-B-IC
 - 835-B
 - 835-B-IC
 - 835-K

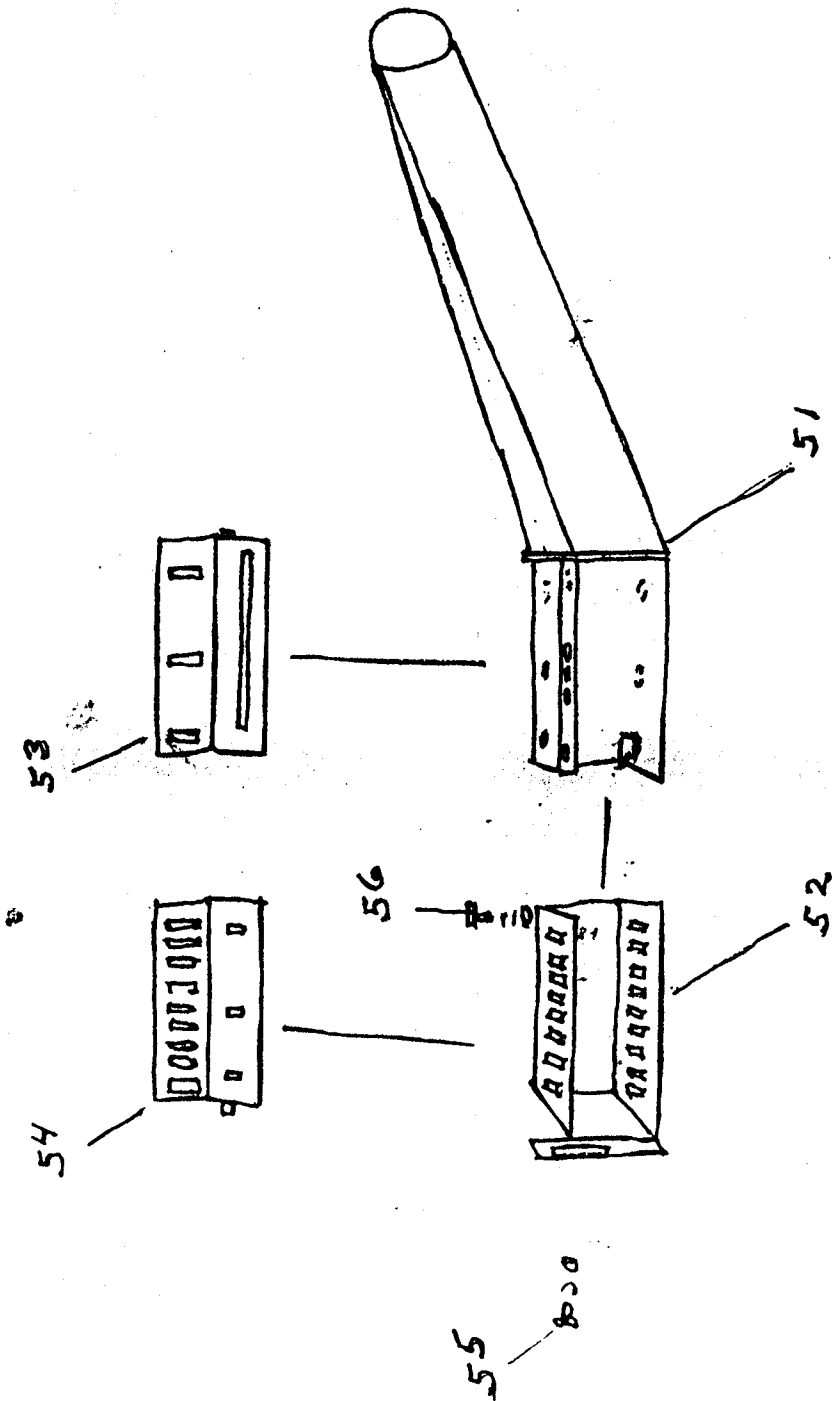

MOWER CHUTE FOR MODELS:
 535-B
 535-B-IC
 835-B
 835-B-IC
 835-K