

GIANT-VAC MFG., INCORPORATED
SOUTH WINDHAM, CT 06226
860-423-7741

THE BIG-GIANT LOG SPLITTER
3008-B 3008-K 4808-B 4808-K
3010-B 4810-B 3014-K 4814-K

Your Big-Giant Log Splitter comes complete in one crate with the necessary parts. Inspect your unit for any damage that might have occurred in shipping. If any is found, save the packing container and immediately notify the Transport Carrier who delivered your machine as he is responsible for the damage and is the only one to make any adjustments. Before leaving our plant, all components are completely inspected. All manufacturing dimensions are held to close tolerances, and thus you will have little difficulty in assembling your Log Splitter if you follow these steps.

CALIFORNIA PROPOSITION 65 WARNING

Gasoline and Diesel engine exhaust and some of its constituents are known to the State of California to cause cancer, birth defects and other reproductive harm.

As an owner of off-road gasoline or diesel engine equipment and/or as an employer, you also may have an obligation under the California Occupational Safety and Health Act or under Proposition 65 to warn persons exposed to gas and diesel engine exhaust and/or other Proposition 65 chemicals in and around your workplace. See California Health and Safety Code section 25249.5, Title 22 of the California Code of Regulations at Section 1200 *et seq.*, and Title 8 of the California Code of Regulations Section 5194.

ASSEMBLY: Remove unit from steel crate. Be sure to save nuts and bolts from crate as you will need these to assemble the unit. After removing from the crate, securely block main frame off the ground high enough to install retractable wheels (Ref. #15). Bolts should head in towards main frame. Securely fasten two (2) lock nuts together and install top pin. Next, lower the front of frame to the ground, then assemble rear jack holder and jack together (Ref. #29), install on front part of main frame. Be sure to use lock washer supplied. Install filter holder (Ref. #41) onto top of oil tank with the out position down. Be sure to use Teflon sealant and turn until secure and resembling angle in schematics. Next, install high pressure hose (Ref #46) to outside of pump (Ref. #36). Be sure NOT to over tighten this fitting as it

could result in pump damage. Separate instructions on pump in manual. Read first before installing. Next, install gas tank onto engine. **CAUTION: READ ATTACHED TO START ENGINE. PLEASE READ MOTOR INSTRUCTIONS AS WELL AS HYDRAULIC OIL PUMP SECTION.**

MOTOR INSTRUCTIONS: You have received a complete engine manual with your machine. Especially note instructions on OILING. Fill out the Warranty Card immediately and send it to the engine manufacturer and not to Giant-Vac. Consequently, if any difficulties exist, please contact them, rather than us, as much time will be saved as they would be the only ones to make any adjustments. If you will check the yellow pages in your telephone book, you will find the local engine servicing dealer.

CAUTION: BEFORE STARTING ENGINE

- A. The hydraulic pump can be damaged if run before the hydraulic system has been serviced.
- B. Please follow the engine manual on type of oil and grade of gasoline to be used.
- C. Do not run engine until hydraulic system has been serviced with 16 quarts of Quaker State Dextron 2 or equivalent type automatic transmission fluid.
- D. Securely install the 2 inch ball hitch on the front of the main frame. Next, check to see that all nuts and bolts and hoses are securely tightened.

OPERATING INSTRUCTIONS

CYCLING RAM: Cycle the ram 15 to 20 full strokes to eliminate any trapped air in the hydraulic system. If the ram seems to lunge or moves in surges, some air is still trapped in the system. Continue to cycle the ram through the full stroke until a steady forward and return stroke is obtained.

OPERATING LEVER: Ram movement forward, neutral and reverse is completely controlled by the lever. Pushing the lever forward or towards the wedge will cause the ram to move forward. When the lever is in the center, the ram will not move. Pull the lever for reverse. The lever may be pushed into forward or into reverse at any time during the forward or return stroke.

RETRACT WHEELS: Your Big-Giant Log Splitter may be retracted to the ground for convenient operating. First, the front support stand should be pinned in the up position. Next, lower the back support jack to the ground. Next, remove each axle pin on each wheel axle, then bring the back support up and they will lower to the ground.

PROPER RAM PRESSURE: If unit does not reach proper pressure, remove acorn nut next to operating handle on valve, and turn the threaded plug in one turn at a time. Proper pressure is approximately 3,000 lbs. PSI.

CAUTION: - **DO NOT OVER TIGHTEN THE THREADED PLUG.**

Big-Giant Log Splitter has a patented two-stage hydraulic pump that will switch from high to low speed when under pressure - automatically.

LOG SIZE: Your Big-Giant Log Splitter provides over 18 ton ram pressure and is designed to split most wood 30 inches long by 36 inches in diameter. To split large, tough logs, always place the log on the splitter so as to split first, a side section. Continue to slab split the large log until a medium sized piece remains, then split it down the center.

MAINTENANCE:

- A. Please follow your Engine Manual on type of oil and when to change it.
- B. The oil and oil filter in the hydraulic system should be changed every 40 hours of operation under normal conditions, and more frequently under dusty conditions. To change the oil in the hydraulic system, the RAM should be in returned position, then simply remove the plug located under the tank. Refill with 16 quarts of Quaker State Dextron 2 or equivalent after replacing plug on bottom of tank. To check oil level run the RAM out all the way and there should be three (3) inches oil level in the oil tank.
- C. Keep the top platen where the log and ram travel free from oil and dirt. The guide shoes under the ram will last longer. Dirt mixed with oil acts as an abrasive compound and quickly wears down the ram shoes and top platen.

CHECK ALIGNMENT BEFORE STARTING PUMP

The single common cause of pump failure on start up (AND IS NOT WARRANTED) is failure to correctly mount the flexible coupling on the pump shaft end and/or misaligning the pump/coupling/motor or engine drive.

1. Don't force or pound the pump coupling half over the pump shaft. End thrust could damage the pump internally.
2. The flexible coupling is not a universal joint. Coupling shaft misalignment acts directly on the shaft seal, shaft bearing, and precision-fitted internal parts. Before the initial start up and after mounting pump and piping is complete, take enough time for a final check with a straight edge that the coupling halves are not parallel or angular misaligned (see sketch) or too close and introducing an end thrust to the pump.

SOME MORE CAUTIONS

If you use Teflon tape on your fittings, use only 1-1/2 wraps and none on the first two threads. Special care should be taken to avoid over-tightening pipe connections. Due to the excellent lubricity of the Teflon tape the wrench tightening "feel" is different than when the fitting is dry or pipe doped. You can screw a fitting in and crack the port or distort the casting without getting a "snugged up" feel. A good rule of thumb is to turn the connector (Example 3/ NPTF steel tubing fitting) in about 2-1/2 turns by hand then 1-1/2 turns by wrench into a 3/ NPTF tapped port hole in cast iron. Remember it is usually easier and cheaper to snug up a leaking joint than to replace a component.

Starting the hydraulic pump properly for the first time can save you trouble of a quick failure. Jog the pump several times (alternately start and stop unit) until pump is primed and full flow begins.

Use the recommended CLEAN oil. If pump is noisy it may be an indication of a starving pump, an air leak in the inlet line fittings, too thick oil, or a clogged inlet filter.

If the pump is equipped with an internal relief valve, the pump should not be operated at pressures greater than 80% of the full by-pass setting (i.e., 80% of 2000 PSI = 1600 PSI). Otherwise, it will recirculate hot oil internally overheating the pump and thinning the oil and eventually fail the pump.

GIANT-VAC WARRANTY

GIANT-VAC MFG. INCORPORATED, here-in-after called Giant-Vac, warrants each new Giant-Vac to the original retail purchaser of the new Giant-Vac equipment to be free from manufacturing defects in normal service for a period of 90 days, unless it is used for rental purposes, which limits the warranty to 30 days. This warranty does not apply to engines, tires or other parts that are purchased and warranted by their manufacturer. Items such as bags, grass catchers, hoses and blades are not warranted, as these are considered expendable items. This warranty does not include equipment failures due to normal wear.

Any obligation under this warranty is expressly limited to the replacement or repair, at an authorized servicing Giant-Vac dealer, or at a point designated by us, of such parts as appear to us to have been defective. All defective parts have to be returned freight prepaid before credit will be issued.

We shall not be liable for transportation charges in connection with the replacement or repair of defective parts.

This warranty does not apply to a Giant-Vac upon which repairs or alterations have been made by others except with our prior written approval.

We shall not be liable for consequential damages or contingent liabilities for the fitness of any Giant-Vac for any particular purpose.

We make no other express, implied or statutory warranty, nor is anyone authorized to make any in our behalf.

GIANT-VAC MFG. INCORPORATED
P.O. BOX 195
SOUTH WINDHAM, CT. 06266
PHONE: 860-423-7741 FAX: 860-423-2654

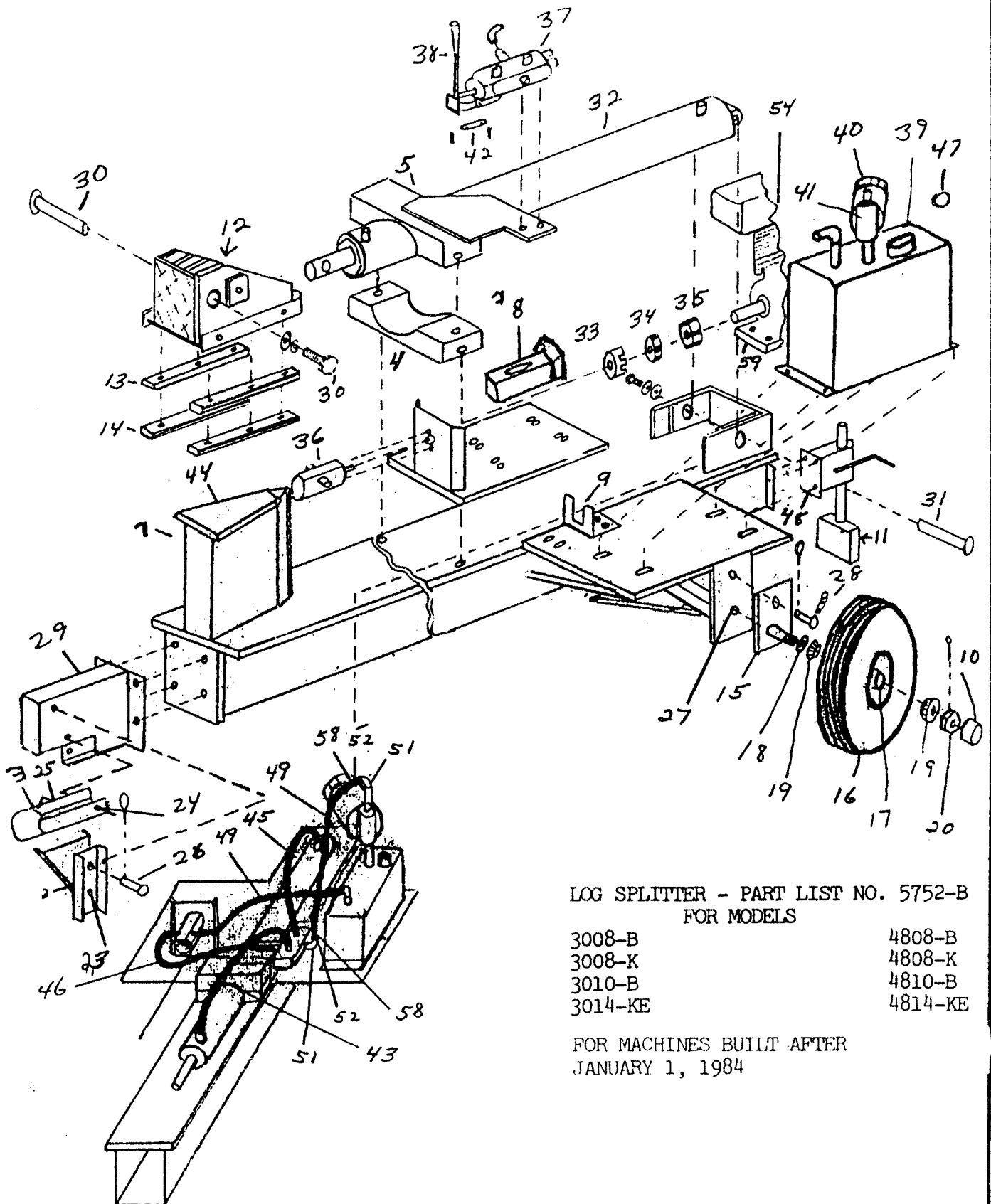

LOG SPLITTER - PART LIST NO. 5752-B
FOR MODELS

3008-B	4808-B
3008-K	4808-K
3010-B	4810-B
3014-KE	4814-KE

FOR MACHINES BUILT AFTER
JANUARY 1, 1984

Parts List No. 5752-B

Ref No	Part No	Description	3008-B 3008-K	4808-B 4808-K	3010-B	4810-B	3014-B	4814-K
1	10068	Main Frame	1					
1	10084	Main Frame		1				
1	10085	Main Frame			1			
1	10086	Main Frame				1		
1	10087	Main Frame					1	
1	10088	Main Frame						1
2	27120	Front Support	1	1	1	1	1	1
3	38013	Ball Hitch 2"	1	1	1	1	1	1
4	27121	Bottom Cylinder Support	1	1	1	1	1	1
5	27122	Top Cylinder Support	1	1	1	1	1	1
8	27145	Pump Mount			8 HP Kohler Models Only			
9	23060	Stroke Control Lower Support	1	1	1	1	1	1
10	33055	Dust Cap	2	2	2	2	2	2
11	33098	Back Support Jack	1	1	1	1	1	1
12	27123	Ram Head	1	1	1	1	1	1
13	27124	Side Ram Guide	2	2	2	2	2	2
14	27125	Lower Ram Guide	2	2	2	2	2	2
15	33083	Retractable Axle	2	2	2	2	2	2
16	33037	Wheel 16" O.D.	2	2	2	2	2	2
17	33058	Hub	2	2	2	2	2	2
18	33057	Seal	2	2	2	2	2	2
19	33056	Bearing	4	4	4	4	4	4
20	31151	Axle Nut	2	2	2	2	2	2
21	31236	3/8 x 1" Bolt, Nut washer	11	11	11	11	11	11
22	31237	1/2 x 1-1/4" Bolt, Nut & Washer	6	6	6	6	6	6
23	31238	Support Pin Front	1	1	1	1	1	1
24	31240	1/2" x 4: Bolt, Nut & Washer	1	1	1	1	1	1
25	31239	1/2" x 1 3/4" Bolt, Nut & Washer	2	2	2	2	2	2
26	31241	1/2" x 2 1/4" Bolt, Nut & Washer	1	1	1	1	1	1
27	31242	Axle, Bolt & Locknut	2	2	2	2	2	2
28	31243	Axle Pin	2	2	2	2	2	2
29	33099	Front Hitch	1	1	1	1	1	1
30	31245	Front Ram Pin	1	1	1	1	1	1
30	31245	Front Ram Pin	1	1	1	1	1	1
31	31246	Back Ram Pin	1	1	1	1	1	1
32	61000	Cylinder 30"	1		1		1	
32	61033	Cylinder 78"		1		1		1
33	31247	Coupling Pump Half	1	1	1	1	1	1
34	31248	Insert Spider	1	1	1	1	1	1
35	31249	Coupling Engine Half	1	1	1	1	1	1
36	61001	Two Stage Pump	1	1	1	1	1	1

The Big Giant Log Splitter Operating Manual

Parts List No. 5752-B

Ref No.	Part No.	Description	3008-B 3008-K	4808-B 4808-K	3010-B	4810-B	3014-B	4814-K
37	61002	Valve	1	1	1	1	1	1
38	23062	Valve Control Lever	1	1	1	1	1	1
39	61036	Tank	1	1	1	1	1	1
40	61037	Filter	1	1	1	1	1	1
41	61038	Filter Holder	1	1	1	1	1	1
42	23063	Control Lever Holder	1	1	1	1	1	1
43	61006	½x23" HiPressure Hose	1	1	1	1	1	1
44	27144	Wedge Only	1	1	1	1	1	1
45	61008	½x35" HiPressure Hose	1		1		1	
45	61034	½x53" HiPressure Hose		1		1		1
46	61009	½x32" HiPressure Hose	1	1	1	1	1	1
47	61035	Oil Tank Cap	1	1	1	1	1	1
48	33100	Back Jack Stand Holder	1	1	1	1	1	1
49	61012	Low Pressure Hose 20"	2	2	2	2	2	2
51	61013	¾" Street Elbow	3	3	3	3	3	3
52	61014	¾" Hose Connector	4	4	4	4	4	4
54	35000	Throttle Control	1	1	1	1	1	1
55	23064	Rod ½" x 6¾"	1	1	1	1	1	1
58	34039	1" Hose Clamp	4	4	4	4	4	4
59	31342	Motor Spacer	2	2				
		8HP Kohler Only						
	39002	8HP B&S Engine						
	39007	8HP Koh Engine						
	39029	10HP B&S Engine						
	39028	14HP Koh Elec Engine						

For Machines Built After January 1, 19984