

OPERATING INSTRUCTIONS  
FOR  
GIANT-BLO MODELS 50-B - 80-B - 80-K - 11-B  
50-B-IC - 80-B-IC

As you unpack your Giant-Blo power unit, you will find the following parts:

- 1 - Power unit with motor, impeller and wheels mounted.
- 1 - Set of handles in three parts.
- 1 - Handle Brace.
- 1 - Package of nuts, bolts and washers.

Inspect parts for any damage that might have occurred in shipping. If any is found, save the packing box and IMMEDIATELY notify the transport carrier who delivered your machine as he is responsible for the damage and is the only one to make any adjustments. Before leaving our plant, all components were thoroughly inspected. All manufacturing dimensions are held to close tolerances, and thus, you will have little difficulty in assembling your Giant-Blo if you follow these steps.

MOTOR INSTRUCTIONS: You have received a complete engine manual with your machine. Be sure to especially note instructions on OILING. FILL OUT THE WARRANTY CARD IMMEDIATELY and send it to the engine manufacturer as directed, as they are responsible for the operation of this engine and will service it. If you have any difficulties with the engine, it is best to contact the engine manufacturer rather than us, as much time will be saved.

HANDLE AND THROTTLE CONNECTIONS: The handles are made in three parts and have a telescopic fit. The handles and handle brace should be completely assembled and then fastened to the blower as a unit. When assembling the handles, it is important that you DO NOT TIGHTEN ANY OF THE BOLTS UNTIL THE ASSEMBLY OPERATIONS ARE COMPLETE. With the bolts loose, there will be enough movement to permit fast and easy assembly. Proceed as follows: Insert the two lower handles into the top handle until the bolt holes are in line. Fasten the handle brace to the handles with two 5/16" diameter bolts 1 3/4" long, lockwashers and nuts. DO NOT TIGHTEN THESE BOLTS. The handle assembly is now ready to attach to the blower. Fasten the lower handle to the blower base with four 5/16 inch diameter bolts 1 3/4 inches long, lockwashers and nuts. DO NOT TIGHTEN THESE BOLTS. Next, install the handle brace to the stud on the blower machine, tighten all bolts. Secure the throttle lever to the handle cable with a clip on the upper handle just above the handle brace connection. Secure the cable with another clip to the lower handle at a height approximately the same level as the recoil starter. Make sure you have left a generous loop between the motor and the bottom clip. This is very IMPORTANT in order that the throttle does not bind. After starting your engine, adjust the length of cable by loosening the screw at the throttle control for proper motor operation.

FRONT BAFFLE PLATE: The front baffle plate is installed to the blower with four 5/16 inch nuts and lockwashers. It is important that the baffle plate be mounted whenever the machine is running in order to shield the high speed impeller. Remember that high speed moving parts should be treated with care. WE HAVE INSTALLED SAFEGUARDS - BE SURE TO USE THEM.

DISCHARGE DEFLECTOR PLATE: The discharge deflector plate mounted on the exhaust end of the blower can be easily adjusted by two wing nuts which permit you to direct the exhaust at the angle you desire for a specific application. Changing the speed of the engine changes the force of the exhaust. By changing the deflector plate angle and the engine speed, you can move litter into a neat row at a very rapid rate.

ATTACHMENTS:

FORWARD DEFLECTOR PLATE: The forward deflector plate mounted on the exhaust end of the blower is operated by a control lever knob. To operate, push control knob to the front of machine. It is ideal for such things as blowing debris from a wall.

HOSE ATTACHMENTS AND #45 CONNECTOR: Hose attachments are available for various jobs. The intake hose kit is available in various diameters. When mounting the hose kit, first, fasten the hose to the intake flange, This is done by slipping the hose over the connector and fastening securely with hose clamps. Then, put nozzle onto hose with clamp. Next, remove intake baffle from machine. Four 5/16 inch bolts are removed to accomplish this. With these same bolts, install the intake flange. To connect #45 exhaust connector on exhaust end of blower, first take off side deflector plate and with three 5/16 inch bolts and lockwashers, mount #45 on end of blower. This adapter has dual useage. First, a 10' x 6" hose can clamp on to this adapter. Secondly, a burlap bag may be utilized to collect the debris.

WARRANTY: Within 90 days from the purchase date, GIANT-VAC MFG. INCORPORATED will replace free of charge for the original purchaser, any part or parts returned to the factory at South Windham, Connecticut, and found by us to be defective in material and/or workmanship.

MARCH 7, 1985

REF. NO.	PART NO.	DESCRIPTION	50-B	80-B	80-K	11-B	50-B IC	80-B IC
1	10089	Engine & Blower base	1					
1	10094	Engine & Blower base					1	
1	10090	Engine & Blower base						1
1	10095	Engine & Blower base		1				
1	10091	Engine & Blower base						1
1	10078	Engine & Blower base			1			
2	21501	Impeller				1		
2	21503	Impeller	1				1	
2	21503	Impeller		1				1
2	21534	Impeller			1			
2	21539	Impeller 1 1/8" Crankshaft				1		
3	20101	Front baffle plate				1		
3	20180	Front baffle plate	1	1	1		1	1
4	24500	Side air deflector plate				1		
5	24501	Forward air deflector	1	1	1	1	1	1
6	24502	Spring for control lever	1	1	1	1	1	1
7	23026	Control lever	1	1	1	1	1	1
8	31103	Control lever knob	1	1	1	1	1	1
9	35002	Throttle control	1	1	1	1	1	1
9	35001	Throttle control			1	1		
10	23000	Upper handle	1	1			1	1
10	23001	Upper handle	1	1			1	1
11	23003	Handle brace			1	1		
11	23004	Handle brace	1	1			1	1
12	23002	Lower handle right side			1	1		
13	23002	Lower handle left side	1	1	1	1	1	1
14	33000	Wheel 10 x 2.50 semi-pneu	1	1	1	1	1	1
14	33001	Wheel 4.10 x 350 - 4 Pneu.	2	2			2	2
15	31000	Blower wheel snap ring			2	2		
16	31001	Flat washers 5/8"	2	2	2	2	2	2
17	31002	Handle bolts 5/16 x 3/4"	2	2	2	2	2	2
17	31002	Handle bolts 5/16 x 1 3/4"	6	6			6	6
18	31003	Lockwashers 5/16"			8	8		
18	31003	Lockwashers 5/16"			23	23		
19	31004	Nuts 5/16"	21	21			21	21
19	31004	Nuts 5/16"			12	12		
20	31002	Bolts 5/16 x 1 3/4"	10	10			10	10
21	31007	Throttle clips	4	4	4	4	4	4
22	31008	Lockwashers 3/8"	2	2	2	2	2	2
23	31009	Nut 3/8"	1	1	1	1	1	1
24	31010	Bolt, nut & lockwashers 10-24 x 1 1/2"	1	1	1	1	1	1
25	31004	Nut for control lever 5/16"	2	2	2	2	2	2
26	31357	Bolt 3/8 x 2 1/2"***	1	1	1	1	1	1
27	33101	Rub side plate **	1	1	1	1	1	1
28	33102	Rub side plate left **	1	1	1	1	1	1
29	33017	Wheel 6 x 150 **	1	1	1	1	1	1
29	33003	**Complete caster wheel assy.	1	1	1	1	1	1
30	31355	Jam nut 3/8"	1	1	1	1	1	1
31	31013	Lockwasher 1/4"	1	1	1	1	1	1
32	31014	Bushing	1	1	1	1	1	1
33	31015	Screw cap 1/4 x 1/2"	1	1	1	1	1	1
34	31016	Bolt 5/16 x 5/8"	1	1	1	1	1	1
35	Bolt 5/16 x 1/2"		4	4	4	4	4	4

REF. NO.	PART NO.	DESCRIPTION	50-B	80-B	80-K	11-B	50-B IC	80-B IC
36	31019	Impeller bolt & lock-washer 3/8-24 x 1 1/2	1				1	
36	31020	Impeller bolt & lock-washer 7/16-20 x 1 1/2		1	1	1		1
37	24503	#45 Exhaust connector	1	1	1	1	1	1
38	20106	Intake flange 4"	1	1	1		1	1
38	20107	Intake flange 5"	1	1	1		1	1
38	20108	Intake flange 6"	1	1	1		1	1
38	20183	Intake flange 6"				1		
39	34011	Hose clamp 4"	2	2	2		2	2
39	34012	Hose clamp 5"	2	2	2		2	2
39	34013	Hose clamp 6"	2	2	2	2	2	2
40	34002	Intake hose 4" x 10'	1	1	1		1	1
40	34003	Intake hose 5" x 10'	1	1	1		1	1
40	34004	Intake hose 6" x 10'	1	1	1	1	1	1
41	20145	Intake nozzle 4"	1	1	1		1	1
41	20146	Intake nozzle 5"	1	1	1		1	1
41	20147	Intake nozzle 6"	1	1	1	1	1	1
	39001	5HP B&S Engine	1					
	39002	8HP B&S Engine		1				
	39007	8HP Koh. Engine			1			
	39029	11HP B&S Engine				1		
	39034	5HP B&S IC Engine					1	
	39035	8HP B&S IC Engine						1

MARCH 7, 1985

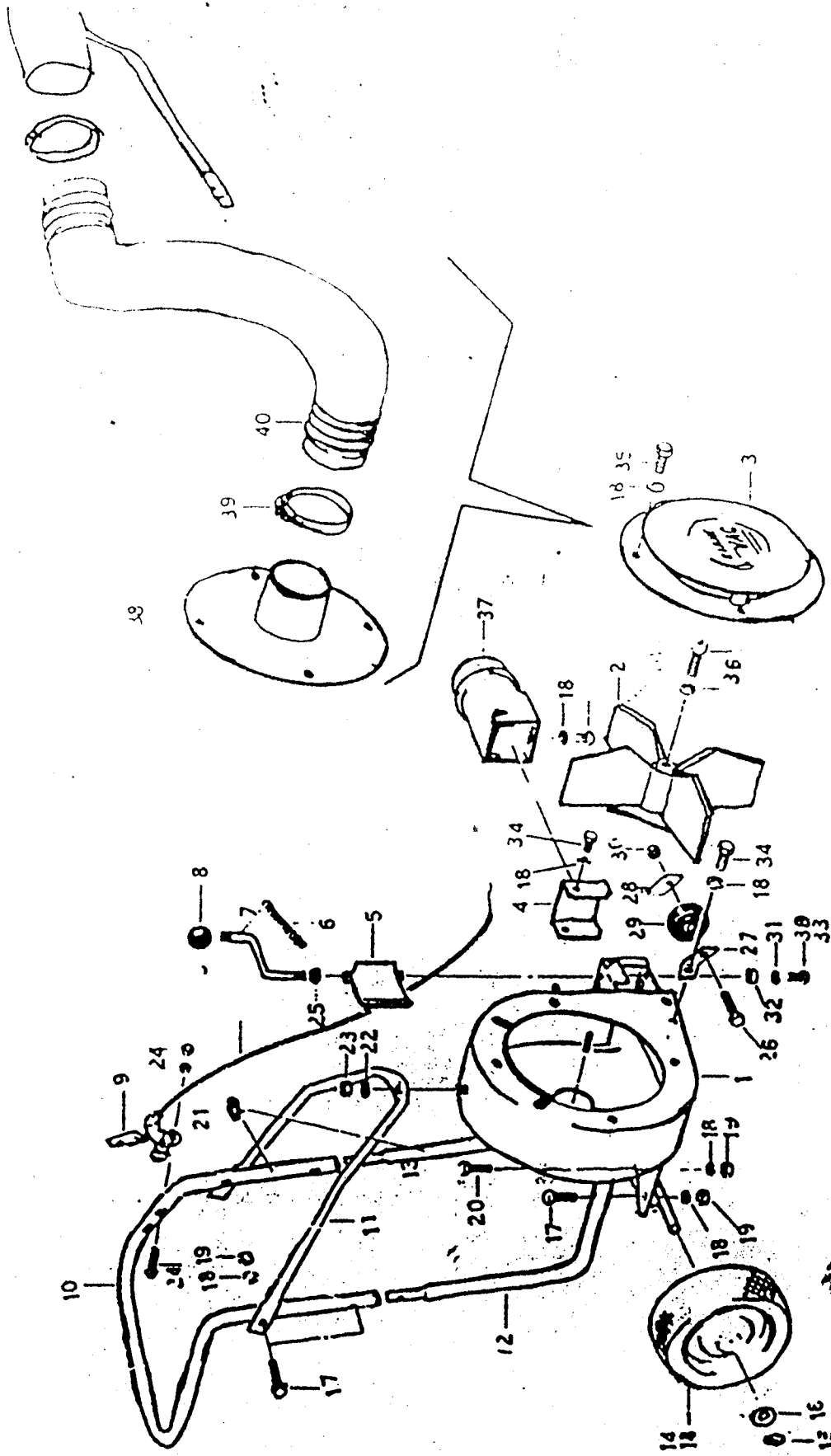

MODELS 5B - 8B - 8K  
GIANT-BLOS